

3. Block Core

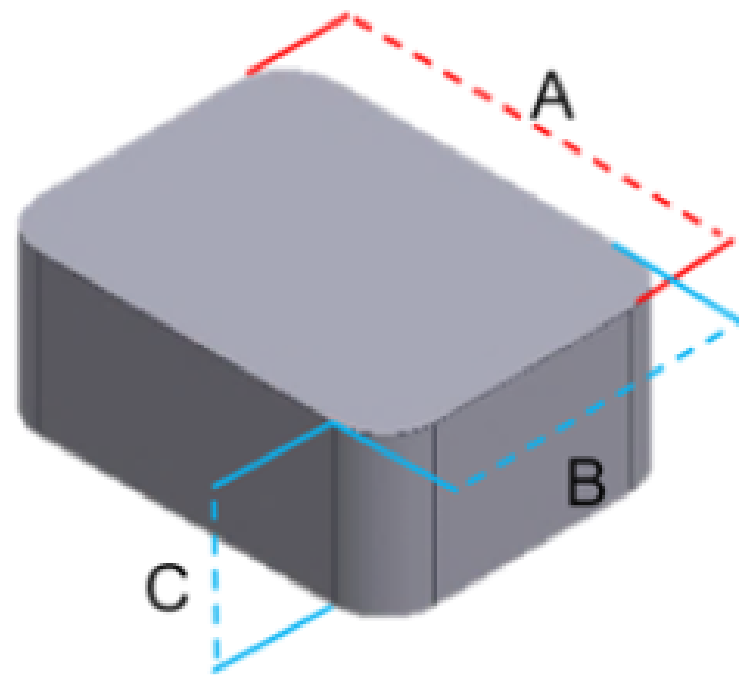

W 80 30 20 C

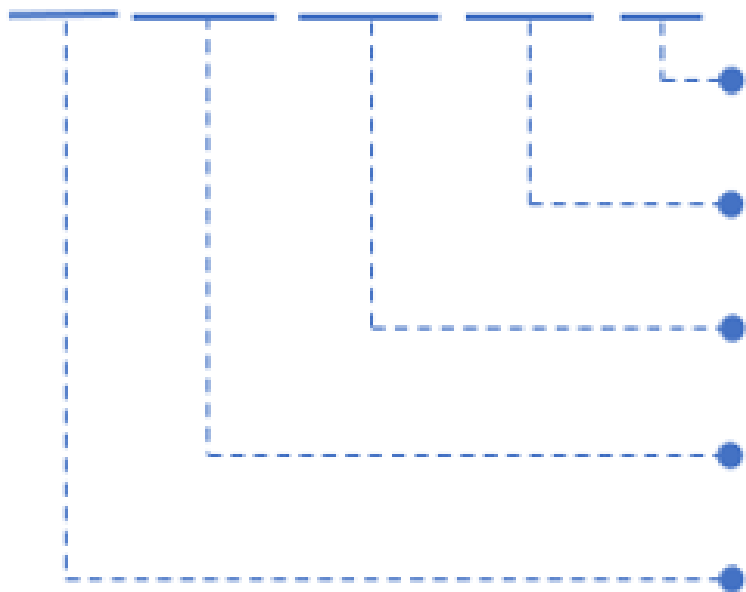

Perm(μ): B:26, J:40, X:50, C:60, D:75, E:90

[C] Size: Height of cores [mm]

[B] Size: Horizontal axis of cores [mm]

[A] Size: Vertical axis of cores [mm]

Material: S:sendust, H:high flux, W:power flux, U:ultra flux

P/N	Dimensions			Path Length(cm)	Cross section Area(cm ²)	AL value (nH/n ²) \pm 12%			
	A (mm)	B (mm)	C(mm)			26u	40u	60u	90u
5315	50.5 \pm 0.5	30.3 \pm 0.3	15 \pm 0.2	18.71	4.5	95	121	181	
5320	50.5 \pm 0.5	30.3 \pm 0.3	20 \pm 0.2	18.28	6	130	165	247	
6315	60.5 \pm 0.5	30.3 \pm 0.3	15 \pm 0.2	22.71	4.5	79	100	149	
6320	60.5 \pm 0.5	30.3 \pm 0.3	20 \pm 0.2	22.28	6	107	135	203	
7315	70.5 \pm 0.5	30.3 \pm 0.3	15 \pm 0.2	26.71	4.5	67	85	127	
7320	70.5 \pm 0.5	30.3 \pm 0.3	20 \pm 0.2	26.28	6	91	115	172	
8315	80.5 \pm 0.5	30.3 \pm 0.3	15 \pm 0.2	30.71	4.5	58	74	110	
8320	80.5 \pm 0.5	30.3 \pm 0.3	20 \pm 0.2	30.28	6	78	100	149	
9315	90.5 \pm 0.5	30.3 \pm 0.3	15 \pm 0.2	34.71	4.5	51	65	98	
9320	90.5 \pm 0.5	30.3 \pm 0.3	20 \pm 0.2	34.28	6	68	88	132	
5020A	50.5 \pm 0.5	20.3 \pm 0.3	20 \pm 0.2	18.28	4	87	110	165	
6020A	60.5 \pm 0.5	20.3 \pm 0.3	20 \pm 0.2	22.28	4	71	90	135	
6020B	60.5 \pm 0.5	20.3 \pm 0.3	25 \pm 0.2	21.85	5	91	115	173	
7020A	70.5 \pm 0.5	20.3 \pm 0.3	20 \pm 0.2	26.28	4	60	77	115	
7020B	70.5 \pm 0.5	20.3 \pm 0.3	25 \pm 0.2	25.85	5	77	97	146	
8020A	80.5 \pm 0.5	20.3 \pm 0.3	20 \pm 0.2	30.28	4	52	66	100	
8020B	80.5 \pm 0.5	20.3 \pm 0.3	25 \pm 0.2	29.85	5	66	84	126	

Power Flux material is only available up to 75 μ .